

VENETIAN®

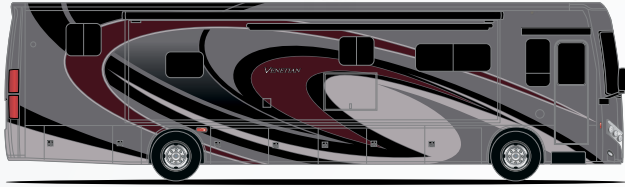

BELLINI

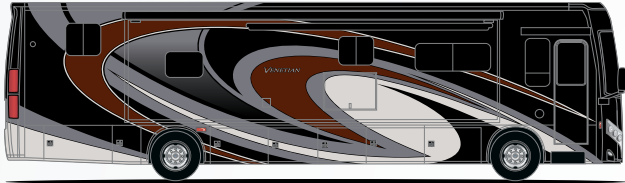

POMPEII



SEACLIFF

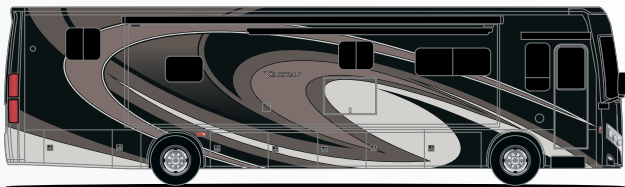

VOGUE



ARTIC CLOUD

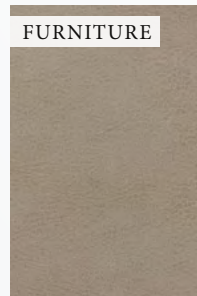

CALYPSO



FRESCO

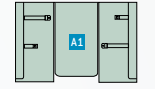
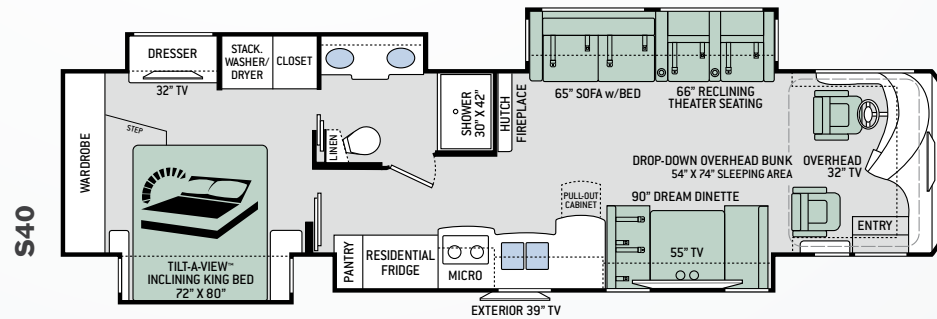
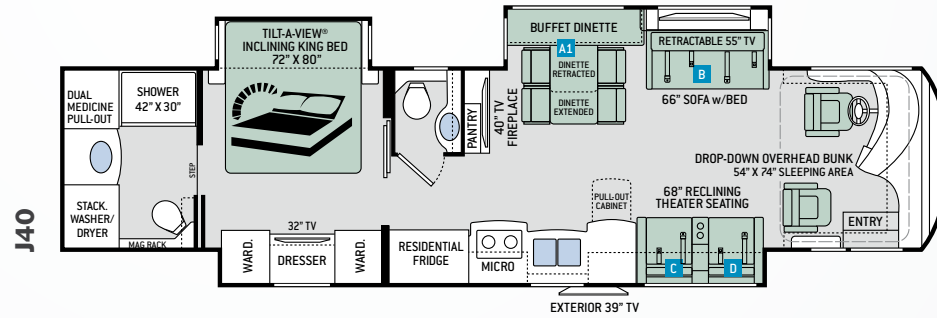
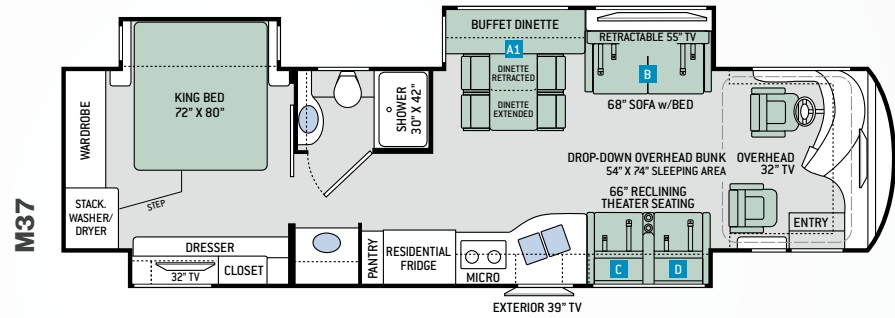
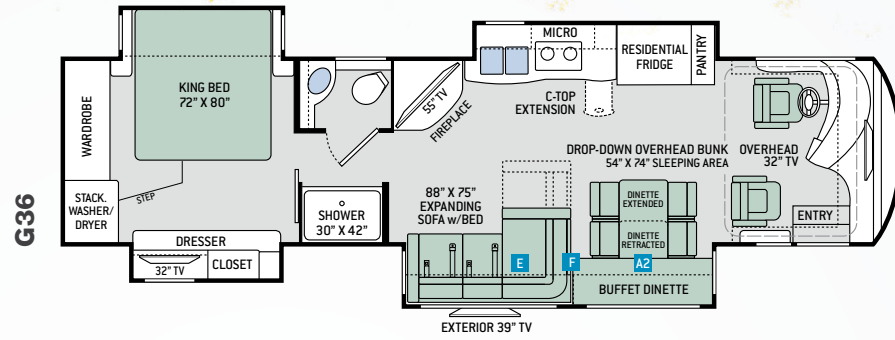

OPTIONAL 74" DREAM DINETTE

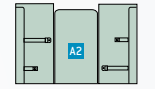

OPTIONAL 74" DREAM DINETTE



OPTIONAL EURO RECLINER w/DESKTOP

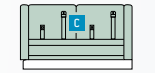

OPTIONAL 66" SOFA w/BED
(EURO RECLINER w/DESKTOP REQUIRED)

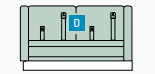

OPTIONAL 66" JACK-KNIFE SOFA

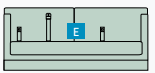

OPTIONAL 88" SOFA w/BED

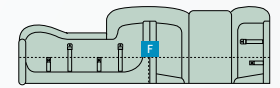

OPTIONAL 162" SOFA ENSEMBLE INCLUDES
88" SOFA w/BED & 74" DREAM DINETTE

Featured Highlights

CONSTRUCTION & EXTERIOR

- Freightliner® XC-R Raised Rail Chassis with Atlas™ Foundation
- Cummins® ISL 8.9L Engine with 400HP & 1,250 lb.-ft. Torque
- In-Block 750-watt Engine Heater
- 6-Speed Allison MH-3000 Automatic Transmission
- Air-Ride™ Suspension
- I-Beam Front Axle with 55" Wheel Cut
- Exhaust Brake
- Sachs® Shock Absorbers
- 150-gallon Fuel Tank with Dual Fills
- One-Piece Fiberglass Front & Rear Caps
- One-Piece Tinted Windshield
- Molded Fiberglass Roof
- Full-Body Paint Package with Invisible Front Mask Paint Protection
- Full Width Stainless Steel Guard with Venetian® Emblem
- Automatic Leveling Jacks with Touchpad Controls
- Side-Hinged Locking Compartment Doors
- Lighted Storage Compartments
- Basement Pass-Through Storage
- Easy Slide Storage Tray
- Power Entry Door & Patio Awnings with Integrated LED Lighting
- Slideout Room Topper Awnings
- Patio Light on Road Side & Curbside
- Electric Entry Steps
- Roof Ladder
- Frameless Dual Pane Windows
- 10,000-lb. Trailer Hitch with 7-pin Round Connector

AUTOMOTIVE & COCKPIT

- Touchscreen Dash Radio with Bluetooth®, Garmin® RV Navigation & SiriusXM® Radio
- Chrome Heated/Power Mirrors with Integrated Side View Cameras
- Push Button Start
- Leatherette Reclining/Swivel Power Adjustable Captain's Chairs (Passenger Seat has Electric Footrest)
- Driver & Passenger Overhead Storage Cabinetry
- Keyless Entry System
- VIP Tilt/Telescoping Smart Wheel
- Cruise Control
- Emergency Engine Start Switch
- Air Horns
- Fog Lights
- Map Lights
- Dash Fans
- Power Solar & Privacy Shades on Windshield
- Manual Solar & Privacy Shades on Side Windows
- Solid Surface Entry Steps with Electric Step Cover
- 275/80R 22.5" Radial Tires with Aluminum Wheels
- Power Drop-Down Hide-Away Overhead Bunk with Cotton Cloud™ Mattress

AUTOMOTIVE & COCKPIT OPTIONS

- Remove Power Drop-Down Hide-Away Overhead Bunk with Cotton Cloud™ Mattress

INTERIOR

- Polished Porcelain Tile Flooring
- Ceiling Ducted Whisper Air™ Central Cooling System
- LED Lighting with Living Room Pin-up Lights

- High-Gloss Glazed Cabinetry with Solid Wood Raised Panel Cabinet Doors & Nickel Finish Hardware
- Solid Wood Veneer
- Window Solar & Privacy Shades
- Leatherette Furniture
- Expanding Sofa with Bed (G36)
- Driver Side Sofa with Bed (M37 & J40)
- Reclining Theater Seating with Footrests (M37 & J40)
- Driver Side Sofa & Theater Seating Combo (S40)
- Buffet Dinette with Four (4) Chairs – Includes Two (2) Folding (G36, M37 & J40)
- Electric Fireplace with Remote Control (G36, J40 & S40)

INTERIOR OPTIONS

- Passenger Side Sofa with Bed (G36)
- Passenger Side Ensemble with Sofa & Dream Dinette® (G36)
- Passenger Side Jack-Knife Sofa (M37 & J40)
- Passenger Side Sofa with Bed – Euro Recliner, Desktop & Electric Fireplace with Remote Control Option Required (M37 & J40)
- Euro Recliner, Desktop & Electric Fireplace with Remote Control (M37)
- Euro Recliner & Desktop (J40)
- Dream Dinette® Booth with Cup Holders (STD S40)

KITCHEN

- 21 cu. ft. Stainless Steel Residential Refrigerator with In-Door Ice & Water Dispenser
- Electric Induction Cooktop
- Decorative Tile Backsplash
- 1.9 cu. ft. Stainless Steel Over-the-Range Convection Microwave Oven

- Solid Surface Countertops & Sink Covers
- Pop-Up Outlets in Kitchen Countertops
- Large Double Bowl Stainless Steel Sink with Single Handle Faucet & Pull-Down Sprayer
- Designer Tile Backsplash
- 12-volt Attic Fan with Cover

BEDROOM & BATHROOM

- Denver Mattress® Pillowtop King Size Bed (G36 & M37)
- Denver Mattress® King Size Bed w/Tilt-A-View™ Inclinable Mechanism (J40 & S40)
- Bedspread with Throw Pillows
- Ceiling Fan in Bedroom
- USB Charging Ports in Nightstands
- Porcelain Toilet
- Macerator Toilet (J40)
- Solid Surface Countertops
- Granite Texture Fiberglass Shower with Glass Door
- Designer Tile Backsplash in Bathroom
- 12-volt Attic Fan with Cover in Bathroom

ENTERTAINMENT

- 55" LED Smart HDTV in Living Area
- 40" LED HDTV & 55" LED Smart HDTV in Living Area (J40)
- 32" LED HDTV in Cockpit Overhead (G36, M37 & S40)
- JBL® Sound Bar with Bluetooth® in Living Area
- Sony® Blu-Ray Players in Living Area & Bedroom
- 32" LED HDTV in Bedroom
- Exterior 39" LED HDTV on Manual Swivel with Bluetooth® Sound Bar
- Cable TV & HDMI Video Distribution Ready
- Winegard® Trav'ler Satellite Dish (HD Capable with DirecTV in U.S. & Shaw Direct in Canada)
- Winegard® ConneCT 4G/Wifi-System

ELECTRICAL & PLUMBING

- Cummins Onan® RV QD 8000 Diesel Generator
- Automatic Generator Start
- 50-amp Shoreline Power Cord
- 2000-watt Pure Sine Inverter/100-amp Converter
- Dual 15,000 BTU Low-Profile Ducted Air Conditioners with Two (2) Heat Pumps
- A/C Condensation Drainage System
- Energy Management System
- Multiplex Wiring Control System with 7" Touchscreen & App-Enabled
- 100-watt Solar Charging System with Power Controller
- Four (4) Auxiliary House Batteries
- Battery Disconnect Switch
- Exterior GFCI Recept
- Aqua-Hot® 200P Hydronic Furnace & Unlimited Water Heating System
- Water Heater By-Pass System
- 360° Siphon RV Holding Tank Vent Cap
- Enclosed & Heated Holding Tanks
- E-Z Flow Water Panel with Whole-House Water Filtration
- Black Tank Flush System
- Outside Shower
- Stackable Washer & Dryer
- Central Vacuum System with Toe-Kick Dustpan

For a complete listing of available features, visit thormotorcoach.com/venetian.

	G36	M37	J40	S40
Chassis	Freightliner XC-R	Freightliner XC-R	Freightliner XC-R	Freightliner XC-R
Gross Vehicle (GVWR)	38,320	38,320	38,320	38,320
Gross Combined (GCWR)	48,320	48,320	48,320	48,320
Wheel Base	236"	242"	272"	272"
Exterior Length	38'	38'-6"	41'	41'
Exterior Height (w/AC)	12'-10"	12'-10"	12'-10"	12'-10"
Exterior Width (w/o mirrors)	101"	101"	101"	101"
Interior Height (living area)	85"	85"	85"	85"
Awning Size	13'-1"	16'-5"	16'-5"	16'-4"
Fuel (gal)	150	150	150	150
Fresh/Waste/Gray Water (gal)	91 / 51 / 51	91 / 51 / 51	91 / 51 / 70	91 / 51 / 70
Water Heater (gal)	10	10	10	10
Furnace (BTUs)	35,000	(2) 20,000	(2) 20,000	(2) 20,000
Exterior Storage Capacity (cu. ft.)	185	195	215	225



MILAN



NEWPORT



PACIFIC



IMPORTANT—PLEASE READ: This brochure reflects product design, fabrication, material, components and specifications at the date of printing, which date is disclosed below. Please visit us online at ThorMotorCoach.com or consult with your selling dealership for the latest in standards, options, specification and technical information. Photographs in the brochure may depict optional equipment or may only be available in certain floor plans. Components, appliances and the chassis may have been manufactured in a calendar year before the vehicle's designated model year. All capacities are approximate. The actual length of the vehicle may differ from that indicated in the brochure due to variances in the manufacturing processes and/or installed components. All dry weights are based on standard model features and do not include optional features or equipment. Component part and appliance manufacturers issue limited warranties covering portions of the vehicle not covered under the limited warranty we issue. Copyright Thor Motor Coach, Inc. © MY 04/13/2018



Made to fit.

P.O. Box 1486, Elkhart, IN 46515 Sales Department: 800.860.5658

thormotorcoach.com/venetian

